

HGI Fontana

Hilton Garden Inn Fontana

10543 Sierra Avenue

Fontana Ca, 92337

Phone: 909-822-7300

Fax: 909-822-7400

- Complimentary local Shuttle service Mon thru Fri 7am to 7pm (5mile radius)

- Free Self Parking

- Complimentary WIFI

- Complimentary 24 hour business center

- Onsite Restaurant "The Great American Grill"
Happy Hour 5pm - 7pm
Daily breakfast and dinner



Border Collies In Need

Preferred rate

\$89.00

For a standard guest room with one king bed or two queen size beds, to include fresh continental breakfast for everyone in your guest room.

This rate will expire on Friday June 27th, 2014 and will no longer be available after that date. After June 27th, rooms can still be booked but at the best available rate at that time.

To book your reservation you can call the hotel at 909-822-7300 and ask for the "Border Collies In Need" rate or group code "BNT".

For fast and easy booking you can visit our website at: fontana.hgi.com and click "More Options" and enter "BNT" under group code.

All reservations will require a credit card to guarantee. Should your plans change you have until 4pm on the date of your arrival to cancel and avoid a no show charge of one nights room and tax.

If you have any questions please give me a call and I will be happy to assist you!

We look forward to your arrival.

Thank you,

Cynthia A. Larez

Director of Sales

Hilton Garden Inn Fontana

10543 Sierra Avenue, Fontana, CA.

Email: cynthia.larez@hilton.com

909-822-7300 ext 4907

www.fontana.hgi.com



10543 Sierra Avenue, Fontana, CA 92337
Tel: 909-822-7300 • Fax: 909-822-7400 • fontana.hgi.com



Everything. Right where you need it.®

Location

Just off the 10 Fwy, minutes away from Ontario International Airport. Easy access to many Southern California attractions and destinations including, Center Stage Dinner Theater, Auto Club Speedway, Citizens Bank Arena, Sierra Lakes Golf Club and Big Bear Ski Resorts.

Facilities/Services

- Over 4,000 sq. ft. of flexible function space to accommodate up to 200 guests
- Complimentary wireless high-speed Internet access throughout the hotel and in all meeting rooms
- 115 guest rooms (including 15 suites)
- 100% non-smoking hotel
- Non-smoking rooms and accessible rooms available
- Great American Grill® serving breakfast & dinner
- Pavilion Lounge
- Evening room service
- Outdoor heated pool and whirlpool
- Workout facility and Stay Fit Kit® available for check-out
- 24-hour Pavilion Pantry® convenience mart
- Complimentary 24-hour business center
- Complimentary outdoor self parking
- Valet and self-laundry available

Guest Rooms Feature

- Complimentary wired & wireless high-speed Internet and secure, remote printing to the business center
- Refrigerator, microwave oven and coffeemaker in each room
- Large work desk with convenient desk-level outlets, adjustable lighting and ergonomic Mirra® chair by Herman Miller
- Two telephones featuring voicemail and data port
- Self-adjusting Garden Sleep System® bed in all rooms
- Hair dryer, iron and ironing board
- 32" HDTV with on-demand movies and complimentary HBO®
- USA TODAY® delivered each weekday morning
- Innovative, easy-to-set alarm clock radio with adaptor for portable music player
- Electronic door locks

Hilton HHonors®

- Hilton HHonors is the only guest reward program that lets you earn both hotel points and airline miles for the same stay at more than 3,000 hotels worldwide.
- With the Hilton HHonors Event Planner program, event planners can earn Points & Miles® for qualifying events. Ask your sales person for details.



Hilton HHonors®

For your next meeting, call Hilton Direct® at
1-800-321-3232 or the hotel direct at 909-822-7300
or visit fontana.hgi.com.



Meeting, Convention and Banquet Facilities

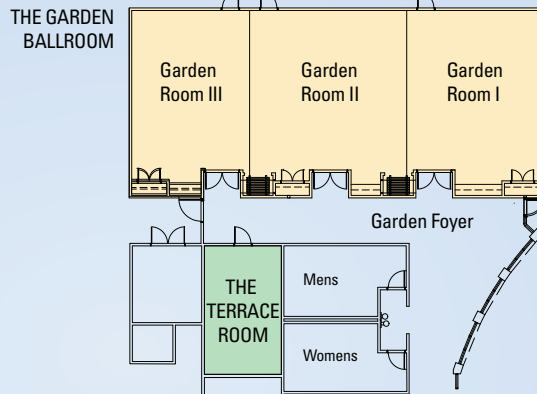
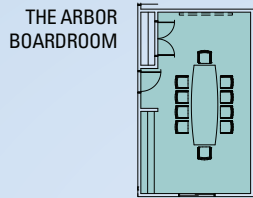

Room Capacities	L x W x H	Square Feet	Classroom	Theater	Banquet 10	Reception	Conference	U-Shape	H-Square
The Arbor Boardroom	17 x 27 x 9'	459	—	—	—	—	15	—	—
The Garden Ballroom	30 x 85 x 9'	2,550	150	300	200	250	75	50	50
The Garden Foyer	30 x 24 x 10'	720	—	—	—	—	—	—	—
The Garden Room I	30 x 28 x 9'	840	30	75	50	75	25	25	30
The Garden Room I and II	30 x 57 x 9'	1,710	65	175	150	175	25	30	30
The Garden Room II	30 x 33 x 9'	990	50	100	75	75	35	30	30
The Garden Room II and III	30 x 58 x 9'	1,740	65	175	150	175	25	30	30
The Garden Room III	30 x 25 x 9'	750	25	50	45	50	25	25	30
The Terrace Room	14 x 24 x 9'	336	15	30	25	30	15	15	20

Actual capacity of rooms is contingent upon the final set for the room. All occupancies are maximum room sets allowable for space, local and state codes. Occupancies may decrease depending upon additional service items in the room, e.g., audio visual equipment, head table, buffet tables, dance floor, etc.